

# REPORT

**Meeting Decision Maker(s)** Licensing Sub-Committee

**Date:** 6<sup>th</sup> October 2020

**Report by:** Susan Vert  
Licensing Officer  
☎ 643 6904

**Contact Officer:** Susan Vert  
Licensing Officer  
☎ 643 6904

**Title of Report:** Licensing Act 2003  
  
99 North Road  
Wallsend  
Tyne and Wear  
NE28 8RJ.

**Ward:** Wallsend

## **1.0 Summary / Purpose of Report**

### **1.1 Licensing Sub-Committee**

The Licensing Act 2003 provides that, where representations have been received from a Responsible Authority or Other Person in respect of an application for a licence, a variation of a licence or a review of a licence, a hearing must be held to consider them, unless the parties and the Authority agree that a hearing is unnecessary. Sub-Committees have been established in accordance with provisions of the Act for the purpose of hearing such applications.

**1.2** The Sub-Committee is asked to consider and determine the application from Mr Mohammad Ali for the grant of a Premises Licence in relation to 99 North Road, Wallsend, Tyne and Wear, NE28 8RJ ("the premises).

**1.3** The applicant has been invited to attend the meeting to put forward their case in support of the application. All persons making relevant representations have also been invited to attend.

## 1.4 Representations from Responsible Authorities and Other Persons

The application has been forwarded to the Chief Officer of Police, Fire Authority, Local Planning Authority, Environmental Health Authority, Health and Safety Enforcement Agency, Licensing Authority, Director of Public Health, Weights and Measures Authority and the Local Safeguarding Children Board with a view to any of these Responsible Authorities inspecting the premises if deemed appropriate by them and to enable them to comment on the application. The application has been advertised near the premises, in a local newspaper and on the Council Website as prescribed.

Representations have been made by the Chief Officer of Police. These are attached at **Appendix 5**.

## 1.5 In relation to an Application for the grant of a Premises Licence the Licensing Sub-Committee can, under the Licensing Act 2003:

- grant a Licence subject to conditions consistent with the operating schedule and appropriate for the promotion of the licensing objectives in addition to the mandatory conditions
- exclude from the scope of the Licence any of the licensable activities to which the Application relates,
- refuse to specify a person in the licence as premises supervisor
- or reject the Application

Once the Sub-Committee have reached a decision, the decision and reasons for the decision must be given in accordance with the **Licensing Act 2003 and the Licensing Act 2003 (Hearings) Regulations 2005**.

## 2.0 Background

This report relates to an application for the grant of a Premise Licence in respect of 99 North Road, Wallsend, Tyne and Wear, NE28 8RJ.

A copy of the application form is attached at **Appendix 1**, a plan of the premises is attached at **Appendix 2** and a map of the area is attached at **Appendix 3**.

## **2.1 The Application for the Grant of a Premises Licence under Section 17 of The Licensing Act 2003**

The Application for Grant of the Premises Licence is made pursuant to Section 17 of the Licensing Act 2003 and the relevant Section of the Act dealing with the determination of such an Application is contained in Section 18 of the Act.

The application for a premise licence is as follows:

### **Supply of Alcohol** (for consumption **off** the premises only)

- Every Day from 08.00 until 23.00

### **General Opening Times** as follows :

- Every Day from 08.00 until 23.00

**2.2** If the licence is granted, this will be subject to Mandatory Conditions which are attached at **Appendix 4** of the report.

## **3.0 Promotion of Licensing Objectives**

The applicant has included the following additional steps in the operating schedule which they intend to take in order to promote the licensing objectives.

Please see **Appendix 1**.

## **4.0 The Parties**

The Parties to the hearing will be:

1. The Applicant – Mr Mohammad Ali
2. Responsible Authorities – Chief Officer of Police

## **5.0 For consideration**

The areas for consideration by the Licensing Sub-Committee are:

- Application for the Grant of a Premises Licence in relation to 99 North Road, Wallsend, Tyne and Wear, NE28 8RJ ("the premises).

## **6.0 The North Tyneside Council Statement of Licensing Policy**

The Sub-Committee's attention is drawn to the relevant part of the Policy - Section 10 Licensing Objectives.

## **7.0 The Revised Guidance issued under Section 182 Licensing Act 2003**

The Sub-Committee's attention is drawn to the relevant parts of the Guidance issued under S182 Licensing Act 2003 - Chapter 2 Licensing Objectives.

## **8.0 For Decision**

The Sub-Committee is asked to determine the application in whatever way it sees fit.

## **9.0 Associated Papers**

Appendix 1 – The application for the Grant of a Premises Licence

Appendix 2 – Plan of the Premises

Appendix 3 – Map

Appendix 4 – Mandatory Conditions

Appendix 5 – Relevant representations

## **10.0 Background Information**

The following background papers have been used in the compilation of this Report and are available for inspection at the offices of the authors of the Report:

North Tyneside Council Statement of Licensing Policy

The Licensing Act 2003 and Regulations

Amended Guidance issued under Section 182 of the Licensing Act 2003 from the Home Office

Delegation Scheme – Licensing Committee 7 February 2005

## **APPENDIX 1**



**North Tyneside**  
**Application for a premises licence**  
**Licensing Act 2003**

For help contact  
[liquor.licensing@northtyneside.gov.uk](mailto:liquor.licensing@northtyneside.gov.uk)  
Telephone: 0191 6432175

\* required information

**Section 1 of 21**

You can save the form at any time and resume it later. You do not need to be logged in when you resume.

System reference

Not Currently In Use

This is the unique reference for this application generated by the system.

Your reference

You can put what you want here to help you track applications if you make lots of them. It is passed to the authority.

Are you an agent acting on behalf of the applicant?

☐ Yes

☒ No

Put "no" if you are applying on your own behalf or on behalf of a business you own or work for.

**Applicant Details**

\* First name

Mohammad

\* Family name

Ali

\* E-mail

Main telephone number

Include country code.

Other telephone number

☐ Indicate here if you would prefer not to be contacted by telephone

Are you:

☐ Applying as a business or organisation, including as a sole trader

☒ Applying as an individual

A sole trader is a business owned by one person without any special legal structure. Applying as an individual means you are applying so you can be employed, or for some other personal reason, such as following a hobby.

**Continued from previous page...**

**Your Address**

Address official correspondence should be sent to.

* Building number or name	<input type="text"/>
* Street	<input type="text"/>
District	<input type="text"/>
* City or town	<input type="text"/>
County or administrative area	<input type="text"/>
* Postcode	<input type="text"/>
* Country	<input type="text"/>

**Section 2 of 21**

**PREMISES DETAILS**

I/we, as named in section 1, apply for a premises licence under section 17 of the Licensing Act 2003 for the premises described in section 2 below (the premises) and I/we are making this application to you as the relevant licensing authority in accordance with section 12 of the Licensing Act 2003.

**Premises Address**

Are you able to provide a postal address, OS map reference or description of the premises?

☒ Address    ☐ OS map reference    ☐ Description

**Postal Address Of Premises**

Building number or name	<input type="text" value="99"/>
Street	<input type="text" value="North Road"/>
District	<input type="text" value="Wallsend"/>
City or town	<input type="text" value="Tyne &amp; Wear"/>
County or administrative area	<input type="text"/>
Postcode	<input type="text" value="NE28 8RJ"/>
Country	<input type="text" value="United Kingdom"/>

**Further Details**

Telephone number	<input type="text"/>
Non-domestic rateable value of premises (£)	<input type="text" value="6,300"/>

### Section 3 of 21

#### APPLICATION DETAILS

In what capacity are you applying for the premises licence?

- ☒ An individual or individuals
- ☐ A limited company / limited liability partnership
- ☐ A partnership (other than limited liability)
- ☐ An unincorporated association
- ☐ Other (for example a statutory corporation)
- ☐ A recognised club
- ☐ A charity
- ☐ The proprietor of an educational establishment
- ☐ A health service body
- ☐ A person who is registered under part 2 of the Care Standards Act 2000 (c14) in respect of an independent hospital in Wales
- ☐ A person who is registered under Chapter 2 of Part 1 of the Health and Social Care Act 2008 in respect of the carrying on of a regulated activity (within the meaning of that Part) in an independent hospital in England
- ☐ The chief officer of police of a police force in England and Wales

#### Confirm The Following

- ☒ I am carrying on or proposing to carry on a business which involves the use of the premises for licensable activities
- ☐ I am making the application pursuant to a statutory function
- ☐ I am making the application pursuant to a function discharged by virtue of Her Majesty's prerogative

### Section 4 of 21

#### INDIVIDUAL APPLICANT DETAILS

##### Applicant Name

Is the name the same as (or similar to) the details given in section one?

☒ Yes ☐ No

If "Yes" is selected you can re-use the details from section one, or amend them as required. Select "No" to enter a completely new set of details.

First name

Family name

Is the applicant 18 years of age or older?

☒ Yes ☐ No



Continued from previous page...

### Current Residential Address

Is the address the same as (or similar to) the address given in section one?

☒ Yes

☐ No

If "Yes" is selected you can re-use the details from section one, or amend them as required. Select "No" to enter a completely new set of details.

Building number or name

Street

District

City or town

County or administrative area

Postcode

Country

### Applicant Contact Details

Are the contact details the same as (or similar to) those given in section one?

☒ Yes

☐ No

If "Yes" is selected you can re-use the details from section one, or amend them as required. Select "No" to enter a completely new set of details.

E-mail

Telephone number

Other telephone number

\* Date of birth

 /  /   
dd mm yyyy

\* Nationality

Documents that demonstrate entitlement to work in the UK

Right to work share code

Right to work share code if not submitting scanned documents

Add another applicant

## Section 5 of 21

### OPERATING SCHEDULE

When do you want the premises licence to start?

 /  /   
dd mm yyyy

If you wish the licence to be valid only for a limited period, when do you want it to end

 /  /   
dd mm yyyy

Provide a general description of the premises

**Continued from previous page...**

For example the type of premises, its general situation and layout and any other information which could be relevant to the licensing objectives. Where your application includes off-supplies of alcohol and you intend to provide a place for consumption of these off- supplies you must include a description of where the place will be and its proximity to the premises.

Proposed use as a convenience store selling a range of alcoholic drinks (for consumption off the premises) and general groceries. Further details of layout etc. are in the attached plans.

If 5,000 or more people are expected to attend the premises at any one time, state the number expected to attend

**Section 6 of 21**

**PROVISION OF PLAYS**

See guidance on regulated entertainment

Will you be providing plays?

☐ Yes

☒ No

**Section 7 of 21**

**PROVISION OF FILMS**

See guidance on regulated entertainment

Will you be providing films?

☐ Yes

☒ No

**Section 8 of 21**

**PROVISION OF INDOOR SPORTING EVENTS**

See guidance on regulated entertainment

Will you be providing indoor sporting events?

☐ Yes

☒ No

**Section 9 of 21**

**PROVISION OF BOXING OR WRESTLING ENTERTAINMENTS**

See guidance on regulated entertainment

Will you be providing boxing or wrestling entertainments?

☐ Yes

☒ No

**Section 10 of 21**

**PROVISION OF LIVE MUSIC**

See guidance on regulated entertainment

Will you be providing live music?

☐ Yes

☒ No

**Section 11 of 21**

**PROVISION OF RECORDED MUSIC**

See guidance on regulated entertainment

*Continued from previous page...*

Will you be providing recorded music?

☐ Yes

☒ No

#### Section 12 of 21

##### PROVISION OF PERFORMANCES OF DANCE

See guidance on regulated entertainment

Will you be providing performances of dance?

☐ Yes

☒ No

#### Section 13 of 21

##### PROVISION OF ANYTHING OF A SIMILAR DESCRIPTION TO LIVE MUSIC, RECORDED MUSIC OR PERFORMANCES OF DANCE

See guidance on regulated entertainment

Will you be providing anything similar to live music, recorded music or performances of dance?

☐ Yes

☒ No

#### Section 14 of 21

##### LATE NIGHT REFRESHMENT

Will you be providing late night refreshment?

☐ Yes

☒ No

#### Section 15 of 21

##### SUPPLY OF ALCOHOL

Will you be selling or supplying alcohol?

☒ Yes

☐ No

##### Standard Days And Timings

###### MONDAY

Start

End

Start

End

###### TUESDAY

Start

End

Start

End

###### WEDNESDAY

Start

End

Start

End

###### THURSDAY

Start

End

Start

End

Give timings in 24 hour clock.  
(e.g., 16:00) and only give details for the days  
of the week when you intend the premises  
to be used for the activity.

**Continued from previous page...**

FRIDAY

Start 08:00

End 23:00

Start 08:00

End 23:00

SATURDAY

Start 08:00

End 23:00

Start 08:00

End 23:00

SUNDAY

Start 08:00

End 23:00

Start 08:00

End 23:00

Will the sale of alcohol be for consumption:

☐ On the premises ☒ Off the premises ☐ Both

If the sale of alcohol is for consumption on the premises select on, if the sale of alcohol is for consumption away from the premises select off. If the sale of alcohol is for consumption on the premises and away from the premises select both.

State any seasonal variations

For example (but not exclusively) where the activity will occur on additional days during the summer months.

Non-standard timings. Where the premises will be used for the supply of alcohol at different times from those listed in the column on the left, list below

For example (but not exclusively), where you wish the activity to go on longer on a particular day e.g. Christmas Eve.

State the name and details of the individual whom you wish to specify on the licence as premises supervisor

**Name**

First name

Ramzan

Family name

Ali

Date of birth

/  /   
dd mm yyyy

**Continued from previous page...**

**Enter the contact's address**

Building number or name

Street

District

City or town

County or administrative area

Postcode

Country

Personal Licence number  
(if known)

Issuing licensing authority  
(if known)

**PROPOSED DESIGNATED PREMISES SUPERVISOR CONSENT**

How will the consent form of the proposed designated premises supervisor be supplied to the authority?

- ☐ Electronically, by the proposed designated premises supervisor
- ☒ As an attachment to this application

Reference number for consent form (if known)

If the consent form is already submitted, ask the proposed designated premises supervisor for its 'system reference' or 'your reference'.

**Section 16 of 21**

**ADULT ENTERTAINMENT**

Highlight any adult entertainment or services, activities, or other entertainment or matters ancillary to the use of the premises that may give rise to concern in respect of children

Give information about anything intended to occur at the premises or ancillary to the use of the premises which may give rise to concern in respect of children, regardless of whether you intend children to have access to the premises, for example (but not exclusively) nudity or semi-nudity, films for restricted age groups etc gambling machines etc.

**Section 17 of 21**

**HOURS PREMISES ARE OPEN TO THE PUBLIC**

**Standard Days And Timings**

MONDAY

Start

End

Start

End

Give timings in 24 hour clock.  
(e.g., 16:00) and only give details for the days of the week when you intend the premises to be used for the activity.

**Continued from previous page...**

**TUESDAY**

Start	<input type="text" value="08:00"/>	End	<input type="text" value="23:00"/>
Start	<input type="text" value="08:00"/>	End	<input type="text" value="23:00"/>

**WEDNESDAY**

Start	<input type="text" value="08:00"/>	End	<input type="text" value="23:00"/>
Start	<input type="text" value="08:00"/>	End	<input type="text" value="23:00"/>

**THURSDAY**

Start	<input type="text" value="08:00"/>	End	<input type="text" value="23:00"/>
Start	<input type="text" value="08:00"/>	End	<input type="text" value="23:00"/>

**FRIDAY**

Start	<input type="text" value="08:00"/>	End	<input type="text" value="23:00"/>
Start	<input type="text" value="08:00"/>	End	<input type="text" value="23:00"/>

**SATURDAY**

Start	<input type="text" value="08:00"/>	End	<input type="text" value="23:00"/>
Start	<input type="text" value="08:00"/>	End	<input type="text" value="23:00"/>

**SUNDAY**

Start	<input type="text" value="08:00"/>	End	<input type="text" value="23:00"/>
Start	<input type="text" value="08:00"/>	End	<input type="text" value="23:00"/>

State any seasonal variations

For example (but not exclusively) where the activity will occur on additional days during the summer months.

Non standard timings. Where you intend to use the premises to be open to the members and guests at different times from those listed in the column on the left, list below

For example (but not exclusively), where you wish the activity to go on longer on a particular day e.g. Christmas Eve.

**Section 18 of 21**

**LICENSING OBJECTIVES**

Describe the steps you intend to take to promote the four licensing objectives:

a) General – all four licensing objectives (b,c,d,e)

**Continued from previous page...**

List here steps you will take to promote all four licensing objectives together.

Strict policies, such as challenge 25, to control which customers are allowed to be sold alcoholic drinks, to ensure no one under age, or in an already intoxicated state can buy alcohol therefore completing all the licensing objectives. Make sure any staff who works there will also be sufficiently trained to follow these objectives and to keep records such as refusal registers to document any incidents.

**b) The prevention of crime and disorder**

Firstly to not sell alcohol to under age persons, already intoxicated persons, or anyone who would provide alcohol to the aforementioned groups to prevent these groups from participating in crime and disorder. Secondly to make use of CCTV in and outside the premises to serve as a deterrent or as a means of passing relevant information to the authorities of any crime and disorder, and to keep an incident book to be made available to the police in the event of any incidents.

**c) Public safety**

As the premises license holder, I am fully aware of my responsibilities under a range of health and safety related legislation, such as first aid, fire safety (fire exits, fire extinguishers etc.) and will have appropriate policies and procedures in place to ensure they are all complied with. Also to make sure that any staff working in the premises will all be trained so they know what to do in the event of any emergencies, or incidents to ensure the public's safety at all times. Also to follow the steps taken to promote the the prevention of crime and disorder which will also keep the public safe.

**d) The prevention of public nuisance**

Any staff will be made aware of the need to have regard to the surrounding area and be aware of the needs of any local residents. To try to prevent any customers of hanging around the shop consuming alcohol or any other gatherings that will create a public nuisance. CCTV will again play a part in promoting this objective, in deterring any behavior that will create nuisance or to provide to the police in the event of any incidents.

**e) The protection of children from harm**

The premises will operate under the recommended Think/Challenge 25 policy, to check the ID of anyone in this age group to ensure that only those with Valid ID, such as passports, driving license, 'PASS' ID cards, who are over the age of 18 will be able to buy alcoholic drinks. Also to make sure any staff working at the premises will be trained to follow these rules.

**Section 19 of 21**

**NOTES ON DEMONSTRATING ENTITLEMENT TO WORK IN THE UK**

*Continued from previous page...*

**Entitlement to work/immigration status for individual applicants and applications from partnerships which are not limited liability partnerships:**

A licence may not be held by an individual or an individual in a partnership who is resident in the UK who:

- does not have the right to live and work in the UK; or
- is subject to a condition preventing him or her from doing work relating to the carrying on of a licensable activity.

Any premises licence issued in respect of an application made on or after 6 April 2017 will become invalid if the holder ceases to be entitled to work in the UK.

Applicants must demonstrate that they have an entitlement to work in the UK and are not subject to a condition preventing them from doing work relating to the carrying on of a licensable activity. They do this in one of two ways: 1) by providing with this application copies or scanned copies of the documents listed below (which do not need to be certified), or 2) by providing their 'share code' to enable the licensing authority to carry out a check using the Home Office online right to work checking service (see below).

**Documents which demonstrate entitlement to work in the UK**

- An expired or current passport showing the holder, or a person named in the passport as the child of the holder, is a British citizen or a citizen of the UK and Colonies having the right of abode in the UK [please see note below about which sections of the passport to copy].
- An expired or current passport or national identity card showing the holder, or a person named in the passport as the child of the holder, is a national of a European Economic Area country or Switzerland.
- A Registration Certificate or document certifying permanent residence issued by the Home Office to a national of a European Economic Area country or Switzerland.
- A Permanent Residence Card issued by the Home Office to the family member of a national of a European Economic Area country or Switzerland.
- A **current** Biometric Immigration Document (Biometric Residence Permit) issued by the Home Office to the holder indicating that the person named is allowed to stay indefinitely in the UK, or has no time limit on their stay in the UK.
- A **current** passport endorsed to show that the holder is exempt from immigration control, is allowed to stay indefinitely in the UK, has the right of abode in the UK, or has no time limit on their stay in the UK.
- A **current** Immigration Status Document issued by the Home Office to the holder with an endorsement indicating that the named person is allowed to stay indefinitely in the UK or has no time limit on their stay in the UK, **when produced in combination with** an official document giving the person's permanent National Insurance number and their name issued by a Government agency or a previous employer.
- A birth or adoption certificate issued in the UK, **when produced in combination with** an official document giving the person's permanent National Insurance number and their name issued by a Government agency or a previous employer.
- A birth or adoption certificate issued in the Channel Islands, the Isle of Man or Ireland **when produced in combination with** an official document giving the person's permanent National Insurance number and their name issued by a Government agency or a previous employer.
- A certificate of registration or naturalisation as a British citizen, **when produced in combination with** an official document giving the person's permanent National Insurance number and their name issued by a Government agency or a previous employer.



**Continued from previous page...**

- A **current** passport endorsed to show that the holder is allowed to stay in the UK and is currently allowed to work and is not subject to a condition preventing the holder from doing work relating to the carrying on of a licensable activity.
- A **current** Biometric Immigration Document (Biometric Residence Permit) issued by the Home Office to the holder which indicates that the named person can currently stay in the UK and is allowed to work relation to the carrying on of a licensable activity.
- A **current** Residence Card issued by the Home Office to a person who is not a national of a European Economic Area state or Switzerland but who is a family member of such a national or who has derivative rights or residence.
- A **current** Immigration Status Document containing a photograph issued by the Home Office to the holder with an endorsement indicating that the named person may stay in the UK, and is allowed to work and is not subject to a condition preventing the holder from doing work relating to the carrying on of a licensable activity **when produced in combination with** an official document giving the person's permanent National Insurance number and their name issued by a Government agency or a previous employer.
- A Certificate of Application, **less than 6 months old**, issued by the Home Office under regulation 18(3) or 20(2), of the Immigration (European Economic Area) Regulations 2016, to a person who is not a national of a European Economic Area state or Switzerland but who is a family member of such a national or who has derivative rights of residence.
- Reasonable evidence that the person has an outstanding application to vary their permission to be in the UK with the Home Office such as the Home Office acknowledgement letter or proof of postage evidence, or reasonable evidence that the person has an appeal or administrative review pending on an immigration decision, such as an appeal or administrative review reference number.
- Reasonable evidence that a person who is not a national of a European Economic Area state or Switzerland but who is a family member of such a national or who has derivative rights of residence in exercising treaty rights in the UK including:-
  - evidence of the applicant's own identity – such as a passport,
  - evidence of their relationship with the European Economic Area family member – e.g. a marriage certificate, civil partnership certificate or birth certificate, and
  - evidence that the European Economic Area national has a right of permanent residence in the UK or is one of the following if they have been in the UK for more than 3 months:
    - (i) working e.g. employment contract, wage slips, letter from the employer,
    - (ii) self-employed e.g. contracts, invoices, or audited accounts with a bank,
    - (iii) studying e.g. letter from the school, college or university and evidence of sufficient funds; or
    - (iv) self-sufficient e.g. bank statements.

Family members of European Economic Area nationals who are studying or financially independent must also provide evidence that the European Economic Area national and any family members hold comprehensive sickness insurance in the UK. This can include a private medical insurance policy, an EHIC card or an S1, S2 or S3 form.

**Original documents must not be sent to licensing authorities.** If the document copied is a passport, a copy of the following pages should be provided:-

- (i) any page containing the holder's personal details including nationality;
- (ii) any page containing the holder's photograph;
- (iii) any page containing the holder's signature;
- (iv) any page containing the date of expiry; and
- (v) any page containing information indicating the holder has permission to enter or remain in the UK and is permitted to work.

**Continued from previous page...**

If the document is not a passport, a copy of the whole document should be provided.

Your right to work will be checked as part of your licensing application and this could involve us checking your immigration status with the Home Office. We may otherwise share information with the Home Office. Your licence application will not be determined until you have complied with this guidance.

#### **Home Office online right to work checking service**

As an alternative to providing a copy of the documents listed above, applicants may demonstrate their right to work by allowing the licensing authority to carry out a check with the Home Office online right to work checking service.

To demonstrate their right to work via the Home Office online right to work checking service, applicants should include in this application their 9-digit share code (provided to them upon accessing the service at <https://www.gov.uk/prove-right-to-work>) which, along with the applicant's date of birth (provided within this application), will allow the licensing authority to carry out the check.

In order to establish the applicant's right to work, the check will need to indicate that the applicant is allowed to work in the United Kingdom and is not subject to a condition preventing them from doing work relating to the carrying on of a licensable activity.

An online check will not be possible in all circumstances because not all applicants will have an immigration status that can be checked online. The Home Office online right to work checking service sets out what information and/or documentation applicants will need in order to access the service. Applicants who are unable to obtain a share code from the service should submit copy documents as set out above.

#### **Section 20 of 21**

#### **NOTES ON REGULATED ENTERTAINMENT**

**Continued from previous page...**

In terms of specific **regulated entertainments** please note that:

- Plays: no licence is required for performances between 08:00 and 23:00 on any day, provided that the audience does not exceed 500.
- Films: no licence is required for 'not-for-profit' film exhibition held in community premises between 08:00 and 23:00 on any day provided that the audience does not exceed 500 and the organiser (a) gets consent to the screening from a person who is responsible for the premises; and (b) ensures that each such screening abides by age classification ratings.
- Indoor sporting events: no licence is required for performances between 08:00 and 23:00 on any day, provided that the audience does not exceed 1000.
- Boxing or Wrestling Entertainment: no licence is required for a contest, exhibition or display of Greco-Roman wrestling, or freestyle wrestling between 08:00 and 23:00 on any day, provided that the audience does not exceed 1000. Combined fighting sports – defined as a contest, exhibition or display which combines boxing or wrestling with one or more martial arts – are licensable as a boxing or wrestling entertainment rather than an indoor sporting event.
- Live music: no licence permission is required for:
  - o a performance of unamplified live music between 08:00 and 23:00 on any day, on any premises.
  - o a performance of amplified live music between 08:00 and 23:00 on any day on premises authorised to sell alcohol for consumption on those premises, provided that the audience does not exceed 500.
  - o a performance of amplified live music between 08:00 and 23:00 on any day, in a workplace that is not licensed to sell alcohol on those premises, provided that the audience does not exceed 500.
  - o a performance of amplified live music between 08:00 and 23:00 on any day, in a church hall, village hall, community hall, or other similar community premises, that is not licensed by a premises licence to sell alcohol, provided that (a) the audience does not exceed 500, and (b) the organiser gets consent for the performance from a person who is responsible for the premises.
  - o a performance of amplified live music between 08:00 and 23:00 on any day, at the non-residential premises of (i) a local authority, or (ii) a school, or (iii) a hospital, provided that (a) the audience does not exceed 500, and (b) the organiser gets consent for the performance on the relevant premises from: (i) the local authority concerned, or (ii) the school or (iii) the health care provider for the hospital.
- Recorded Music: no licence permission is required for:
  - o any playing of recorded music between 08:00 and 23:00 on any day on premises authorised to sell alcohol for consumption on those premises, provided that the audience does not exceed 500.
  - o any playing of recorded music between 08:00 and 23:00 on any day, in a church hall, village hall, community hall, or other similar community premises, that is not licensed by a premises licence to sell alcohol, provided that (a) the audience does not exceed 500, and (b) the organiser gets consent for the performance from a person who is responsible for the premises.
  - o any playing of recorded music between 08:00 and 23:00 on any day, at the non-residential premises of (i) a local authority, or (ii) a school, or (iii) a hospital, provided that (a) the audience does not exceed 500, and (b) the organiser gets consent for the performance on the relevant premises from: (i) the local authority concerned, or (ii) the school proprietor or (iii) the health care provider for the hospital.

**Continued from previous page...**

- Dance: no licence is required for performances between 08.00 and 23.00 on any day, provided that the audience does not exceed 500. However, a performance which amounts to adult entertainment remains licensable.
- Cross activity exemptions: no licence is required between 08.00 and 23.00 on any day, with no limit on audience size for:
  - o any entertainment taking place on the premises of the local authority where the entertainment is provided by or on behalf of the local authority;
  - o any entertainment taking place on the hospital premises of the health care provider where the entertainment is provided by or on behalf of the health care provider;
  - o any entertainment taking place on the premises of the school where the entertainment is provided by or on behalf of the school proprietor; and
  - o any entertainment (excluding films and a boxing or wrestling entertainment) taking place at a travelling circus, provided that (a) it takes place within a moveable structure that accommodates the audience, and (b) that the travelling circus has not been located on the same site for more than 28 consecutive days.

**Section 21 of 21**

**PAYMENT DETAILS**

This fee must be paid to the authority. If you complete the application online, you must pay it by debit or credit card.

Premises Licence Fees are determined by the non-domestic rateable value of the premises.

To find out a premises non domestic rateable value go to the Valuation Office Agency site at [http://www.voa.gov.uk/business\\_rates/index.htm](http://www.voa.gov.uk/business_rates/index.htm)

Band A - No RV to £4300 £100.00

Band B - £4301 to £33000 £190.00

Band C - £33001 to £87000 £315.00

Band D - £87001 to £125000 £450.00\*

Band E - £125001 and over £635.00\*

\*If the premises rateable value is in Bands D or E and the premises is primarily used for the consumption of alcohol on the premises then you are required to pay a higher fee

Band D - £87001 to £125000 £900.00

Band E - £125001 and over £1,905.00

There is an exemption from the payment of fees in relation to the provision of regulated entertainment at church halls, chapel halls or premises of a similar nature, village halls, parish or community halls, or other premises of a similar nature. The costs associated with these licences will be met by central Government. If, however, the licence also authorises the use of the premises for the supply of alcohol or the provision of late night refreshment, a fee will be required.

Schools and sixth form colleges are exempt from the fees associated with the authorisation of regulated entertainment where the entertainment is provided by and at the school or college and for the purposes of the school or college.

If you operate a large event you are subject to ADDITIONAL fees based upon the number in attendance at any one time

Capacity 5000-9999 £1,000.00

Capacity 10000 -14999 £2,000.00

Capacity 15000-19999 £4,000.00

Capacity 20000-29999 £8,000.00

Capacity 30000-39999 £16,000.00

Capacity 40000-49999 £24,000.00

Capacity 50000-59999 £32,000.00

Capacity 60000-69999 £40,000.00

Capacity 70000-79999 £48,000.00

Capacity 80000-89999 £56,000.00

Capacity 90000 and over £64,000.00

\* Fee amount (£)

190.00

**DECLARATION**

**Continued from previous page...**

[Applicable to individual applicants only, including those in a partnership which is not a limited liability partnership] I understand I am not entitled to be issued with a licence if I do not have the entitlement to live and work in the UK (or if I am subject to a condition preventing me from doing work relating to the carrying on of a licensable activity) and that my \* licence will become invalid if I cease to be entitled to live and work in the UK (please read guidance note 15) The DPS named in this application form is entitled to work in the UK (and is not subject to conditions preventing him or her from doing work relating to a licensable activity) and I have seen a copy of his or her proof of entitlement to work, if appropriate (please see note 15)

☒ Ticking this box indicates you have read and understood the above declaration

This section should be completed by the applicant, unless you answered "Yes" to the question "Are you an agent acting on behalf of the applicant?"

\* Full name

\* Capacity

\* Date  /  /   
dd mm yyyy

Once you're finished you need to do the following:

1. Save this form to your computer by clicking file/save as...
  2. Go back to <https://www.gov.uk/apply-for-a-licence/premises-licence/north-tyneside/apply-1> to upload this file and continue with your application.
- Don't forget to make sure you have all your supporting documentation to hand.

**IT IS AN OFFENCE LIABLE TO SUMMARY CONVICTION TO A FINE OF ANY AMOUNT UNDER SECTION 158 OF THE LICENSING ACT 2003, TO MAKE A FALSE STATEMENT IN OR IN CONNECTION WITH THIS APPLICATION**

**IT IS AN OFFENCE UNDER SECTION 24B OF THE IMMIGRATION ACT 1971 FOR A PERSON TO WORK WHEN THEY KNOW, OR HAVE REASONABLE CAUSE TO BELIEVE, THAT THEY ARE DISQUALIFIED FROM DOING SO BY REASON OF THEIR IMMIGRATION STATUS. THOSE WHO EMPLOY AN ADULT WITHOUT LEAVE OR WHO IS SUBJECT TO CONDITIONS AS TO EMPLOYMENT WILL BE LIABLE TO A CIVIL PENALTY UNDER SECTION 15 OF THE IMMIGRATION, ASYLUM AND NATIONALITY ACT 2006 AND PURSUANT TO SECTION 21 OF THE SAME ACT, WILL BE COMMITTING AN OFFENCE WHERE THEY DO SO IN THE KNOWLEDGE, OR WITH REASONABLE CAUSE TO BELIEVE, THAT THE EMPLOYEE IS DISQUALIFIED**

## **APPENDIX 2**

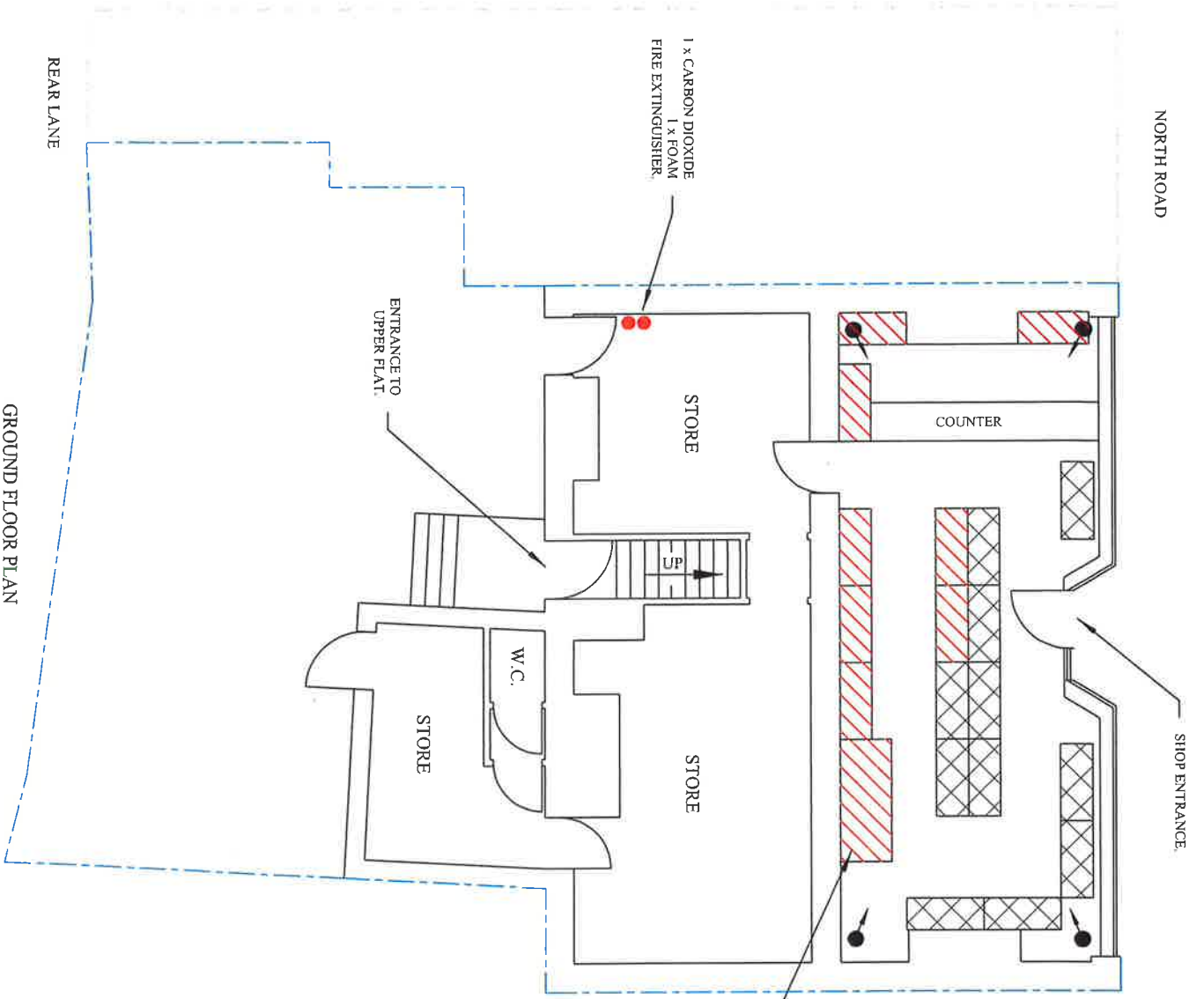

- LEGEND
- = PROPOSED CCTV CAMERAS & DIRECTION
  - = ALCOHOL
  - = GENERAL GROCERIES

DRAWING No. AD-20-14			
CLIENT: MR ALI			
ADDRESS: 99 NORTH ROAD, WALLSEND, TYNE & WEAR, NE28 8RJ			
TITLE: PREMISES LAYOUT			
FOR DRAWINGS TEL:- 0191 4204980 or 079706270053			
REV	DATE	SCALE	SIZE
0	JUNE - 2020	1:100	A4

## **APPENDIX 3**



# 99 North Road

Not Set



North Tyneside Council



Reproduced from the Ordnance Survey material with the permission of Ordnance Survey on behalf of the Controller of Her Majesty's Stationary Office © Crown Copyright 2012. Unauthorised reproduction infringes Crown Copyright and may lead to prosecution or civil proceedings.  
North Tyneside Council © Crown Copyright and database right 2012.  
Ordnance Survey Licence Number 0100016801



Organisation	North Tyneside Council			Date	22 September 2020
Department	North Tyneside Council			SLA Number	100016801
Comments	Not Set			Scale :	1:692

## **APPENDIX 4**

## **Appendix 4**

### **Mandatory Conditions**

#### **Section 19 Licensing Act 2003**

1. No supply of alcohol may be made under this premises licence:-
  - (a) At a time when there is no designated premises supervisor in respect of the premises licence
  - Or
  - (b) At a time when the designated premises supervisor does not hold a personal licence or his personal licence is suspended.
2. Every supply of alcohol under this premises licence must be made or authorised by a person who holds a licence.

#### **The Licensing Act 2003 (Mandatory Licensing Conditions) Order 2014 – with effect from 28<sup>th</sup> May 2014**

1. A relevant person shall ensure that no alcohol is sold or supplied for consumption on or off the premises for a price which is less than the permitted price.
2. For the purposes of the condition set out in paragraph 1—
  - (a) “duty” is to be construed in accordance with the Alcoholic Liquor Duties Act 1979;
  - (b) “permitted price” is the price found by applying the formula—

$$P = D + (D \times V)$$

where—

- (i) P is the permitted price,
  - (ii) D is the amount of duty chargeable in relation to the alcohol as if the duty were charged on the date of the sale or supply of the alcohol, and
  - (iii) V is the rate of value added tax chargeable in relation to the alcohol as if the value added tax were charged on the date of the sale or supply of the alcohol;
- (c) “relevant person” means, in relation to premises in respect of which there is in force a premises licence—
- (i) the holder of the premises licence,
  - (ii) the designated premises supervisor (if any) in respect of such a licence, or
  - (iii) the personal licence holder who makes or authorises a supply of alcohol under such a licence;

(d) "relevant person" means, in relation to premises in respect of which there is in force a club premises certificate, any member or officer of the club present on the premises in a capacity which enables the member or officer to prevent the supply in question; and

(e) "valued added tax" means value added tax charged in accordance with the Value Added Tax Act 1994.

3. Where the permitted price given by Paragraph (b) of paragraph 2 would (apart from this paragraph) not be a whole number of pennies, the price given by that sub-paragraph shall be taken to be the price actually given by that sub-paragraph rounded up to the nearest penny.
4. (1) Sub-paragraph (2) applies where the permitted price given by Paragraph (b) of paragraph 2 on a day ("the first day") would be different from the permitted price on the next day ("the second day") as a result of a change to the rate of duty or value added tax.  
(2) The permitted price which would apply on the first day applies to sales or supplies of alcohol which take place before the expiry of the period of 14 days beginning on the second day.

**The Licensing Act 2003 (Mandatory Licensing Conditions) Order 2010 - with effect from 1st October 2010 as amended on 1st October 2014**

1. (1) The premises licence holder or club premises certificate holder shall ensure that an age verification policy applies to the premises in relation to the sale or supply of alcohol.  
(2) The designated premises supervisor in relation to the premise licence must ensure that the supply of alcohol at the premises is carried on in accordance with the age verification policy.  
(3) The policy must require individuals who appear to the responsible person to be under 18 years of age (or such older age as may be specified in the policy) to produce on request, before being served alcohol, identification bearing their photograph, date of birth and either -
  - (a) a holographic mark, or
  - (b) an ultraviolet feature.

## **APPENDIX 5**





26<sup>th</sup> August 2020

Licensing Officer,  
Licensing Department,  
Killingworth Site,  
Harvey Combe,  
Killingworth,  
Newcastle-Upon-Tyne,  
NE12 6UB.

Northern Area Command  
Bedlington Police Station  
Schalksmuhle Road  
Bedlington  
NE22 7LA

Dear Mrs Graham,

**Re: Application for a Premises Licence at 99 North Road, Wallsend, NE28 8RJ**

**Applicant: - Mr Mohammad Ali.**

In respect of the grant of the above application, I have the following comments to make and wish to lodge the following representation:-

Northumbria Police wish to place an objection to the premises licence application for 99 North Road, Wallsend, on the grounds of Crime and Disorder.

The steps the applicant has placed in the operating schedule do not demonstrate to the police that this business will be properly managed to promote the licensing objectives. There is not enough information for the police to make an informed decision. A telephone conversation took place on Tuesday 24<sup>th</sup> August 2020, to discuss the application. Mr Kirkpatrick (Licensing Officer for the police) spoke to Mr Ali about the application and the wording of the offered conditions.

Mr Ali was very knowledgeable about the business; he informed Mr Kirkpatrick a CCTV system was to be installed inside and outside the premises. There was also a strong challenge 25 policy in place, to only accept a passport, Driving licence or Military ID, along with an incident book and refusals register

Proposed wording of conditions was discussed with Mr Ali for his consideration. A copy of the proposed conditions was sent to Mr Ali on 27<sup>th</sup> August 2020 by email. The licence application in its current form Northumbria police would not support.

Northumbria Police request that the wording in the operating schedule the applicant has offered in his application is modified.

Yours sincerely,

7987

C/Insp Amanda Dumighan 7987.  
Harm Reduction.